



SS22U THRU SS220U

2.0 AMP SURFACE MOUNT SCHOTTKY BARRIER RECTIFIER

Features

- Schottky Brier Chip
- Low Power Loss,High Efficiency
- Ideally Suited for Automatic Assembly
- Surge Overload Rating to 60A Peak
- Plastic Case Material has UL Flammability Classification Rating 94V-0

Mechanical Data

- Case: Molded plastic SMA
- Terminals: Plated leads solderable per MIL-STD-750,Method 2026 guaranteed
- Polarity: Color band denotes cathode end
- Mounting Position: Any
- Making: Type Number

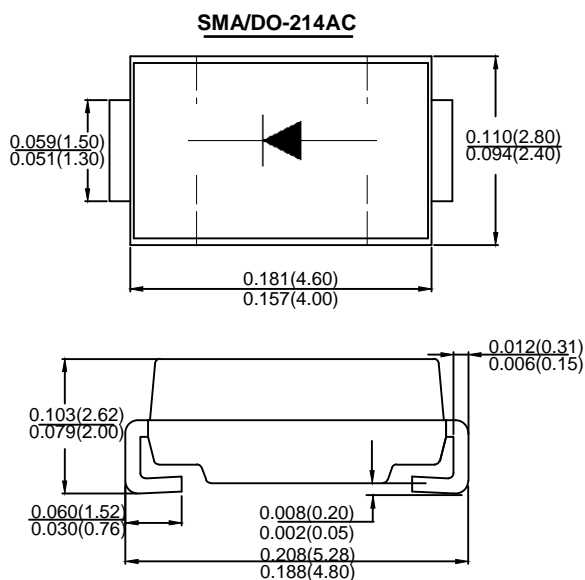

Dimensions in inches and (millimeters)

Maximum Ratings and Electrical Characteristics

Rating at 25°C ambient temperature unless otherwise specified
 Single phase, half wave, 60Hz, resistive or inductive load
 For capacitive load derate current by 20%

Type Number	SYMBOL	SS 22U	SS 23U	SS 24U	SS 245U	SS 25U	SS 26U	SS 28U	SS 210U	SS 215U	SS 220U	Unit	
Maximum Recurrent Peak Reverse Voltage	V_{RRM}	20	30	40	45	50	60	80	100	150	200	V	
Maximum RMS Voltage	V_{RMS}	14	21	28	31	35	42	56	70	105	140	V	
Maximum DC Blocking Voltage	V_{DC}	20	30	40	45	50	60	80	100	150	200	V	
Average Rectified Output Current @ $T_L = 100^\circ\text{C}$	$I_{F(AV)}$	2.0										A	
Peak Forward Surge Current 8.3ms Single half sine-wave superimposed on rated load (JEDEC Method)	I_{FSM}	60										A	
Rating for fusing ($t < 8.3\text{ms}$)	I^2t	14.94										A ² s	
Forward Voltage @ $I_F = 2.0\text{A}$	V_{FM}	0.50			0.67		0.82		0.90			V	
Peak Reverse Current @ $T_A = 25^\circ\text{C}$	I_R	0.1					0.05						mA
At Rated DC Blocking Voltage @ $T_A = 100^\circ\text{C}$		10					5						
Typical Junction Capacitance (Note 1)	C_J	100					50						pF
Typical Thermal Resistance (Note 2)	$R_{\theta JA}$	75										$^\circ\text{C}/\text{W}$	
Operating Temperature Range	T_J	-55 to +150										$^\circ\text{C}$	
Storage Temperature Range	T_{STG}	-55 to +150										$^\circ\text{C}$	

- Note:
1. Measured at 1.0 MHz and Applied reverse Voltage of 4.0V D.C
 2. Device mounted on FR-4 substrate, 1"*1", 2oz, single-sided, PC boards with 0.1"*0.15" copper pad.



SS22U THRU SS220U

Fig. 1 Forward Current Derating Curve

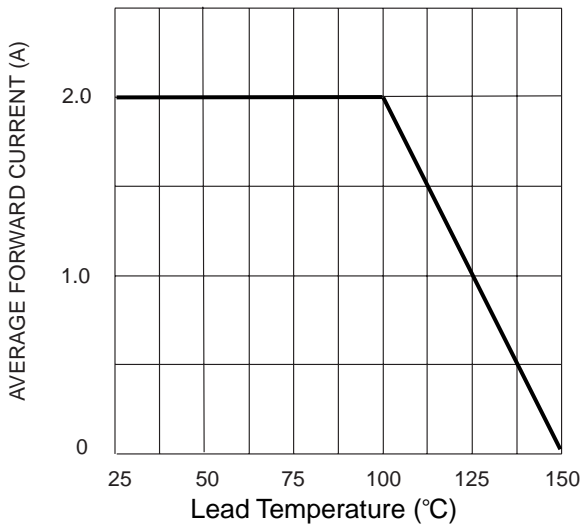

Fig. 2 Typ. Forward Characteristics

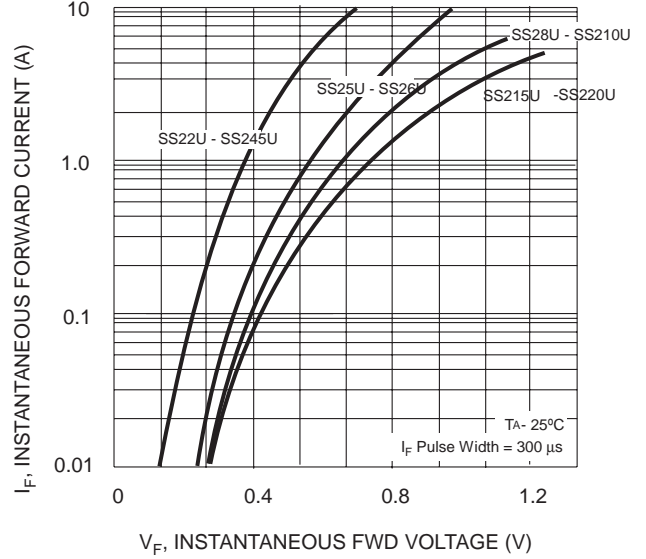

Fig. 3 Max Non-Repetitive Peak Fwd Surge Current

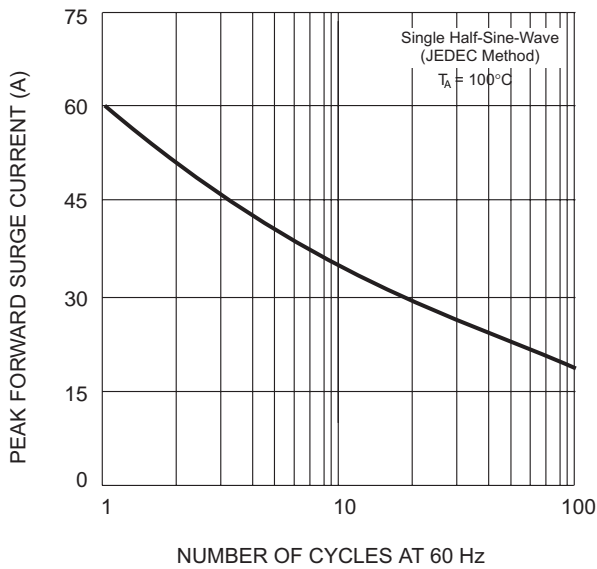
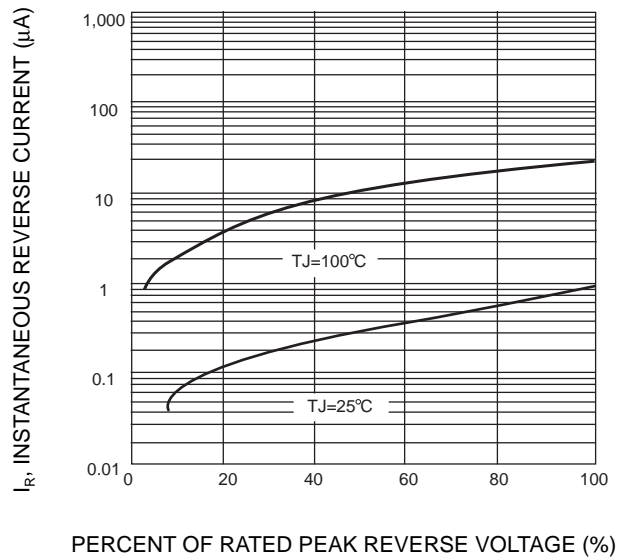
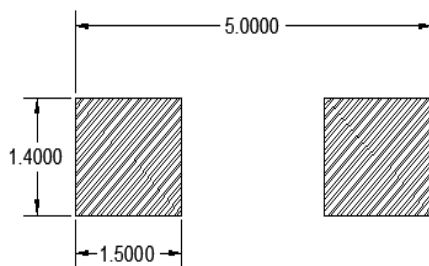

Fig. 4 Typical Reverse Characteristics (per element)



SMA PAD LAYOUT





SS22U THRU SS220U

Important Notice and Disclaimer

- Reproducing and modifying information of the document is prohibited without permission from XINNUO
- XINNUO reserves the right to make changes to this document and its products and specifications at any time without notice. Customers should obtain and confirm the latest product information and specifications before final design, purchase or use.
- XINNUO disclaims any and all liability arising out of the application or use of any product including damages incidentally and consequentially occurred.
- XINNUO does not assume any and all implied warranties, including warranties of fitness for particular purpose, non-infringement and merchantability.
- Applications shown on the here in document are examples of standard use and operation. Customers are responsible in comprehending the suitable use in particular applications.
XINNUO makes no representation or warranty that such applications will be suitable for the specified use without further testing or modification.
- The products shown here in are not designed and authorized for equipments requiring high level of reliability or relating to human life and for any applications concerning life-saving or life-sustaining, such as medical instruments, transportation equipment, aerospace machinery et cetera. Customers using or selling these products for use in such applications do so at their own risk and agree to fully indemnify XINNUO for any damages resulting from such improper use or sale.
- Since XINNUO uses lot number as the tracking base, please provide the lot number for tracking when complaining.